

Seminar Room



Fort Worden

— PORT TOWNSEND —

A HISTORIC GATHERING PLACE

Maximum Capacity:

45

Suitable for:

- * Meetings
- * Presentations
- * Workshops
- * Lectures

Notes:

The perfect gathering place for your small group, includes a blackboard, projections screen, podium, darkening shades, & carpeting.

Example Room Setup:

U—Shaped

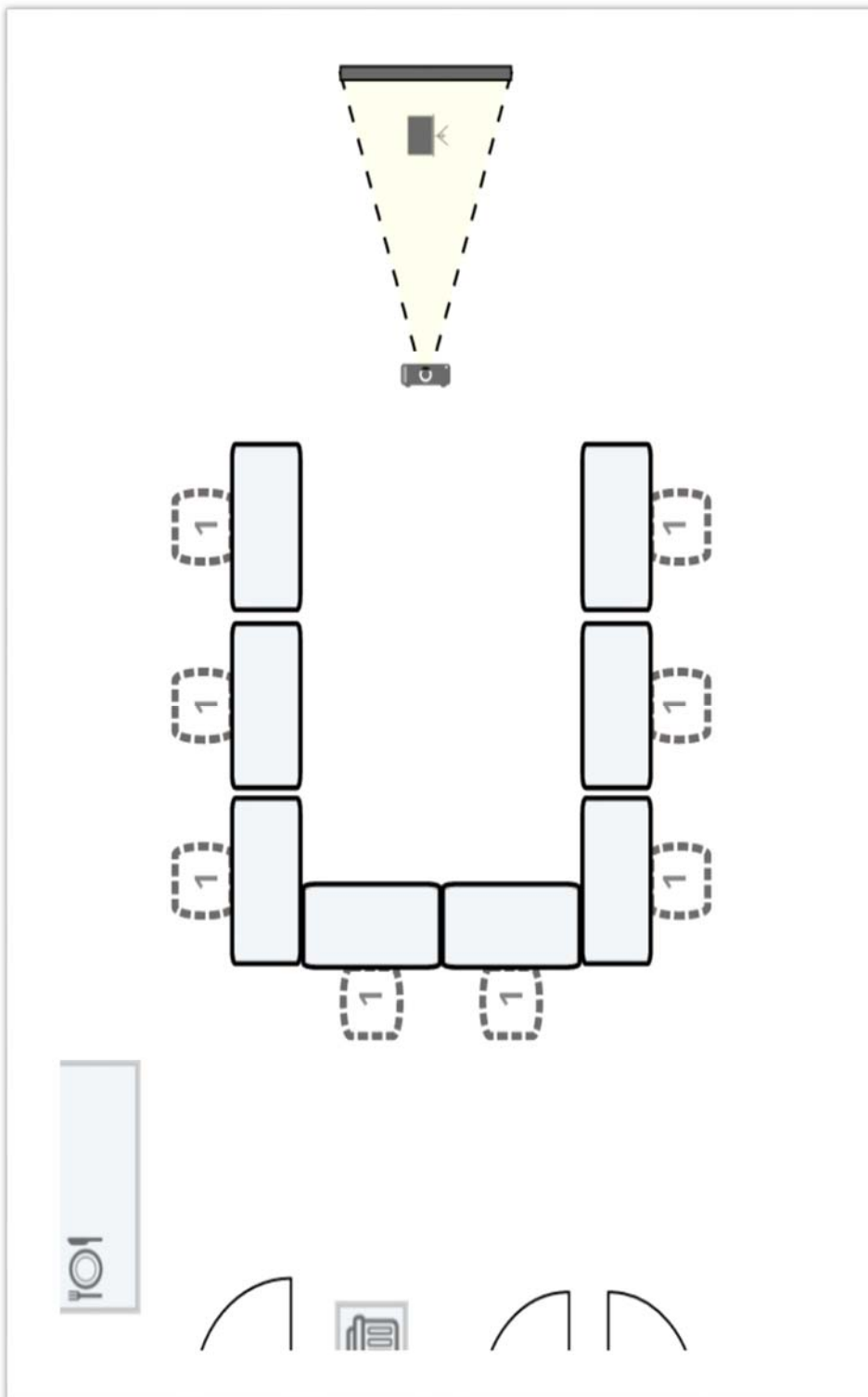

JFK

Building



Fort Worden

— PORT TOWNSEND —

A HISTORIC GATHERING PLACE

Maximum Capacity:

180

Suitable for:

- * Lectures
- * Workshops
- * Receptions
- * Film screenings
- * Dance studio

Notes:

JFK Hall building is newly remodeled and ideal for large groups.

There is a built-in projection screen & a stage.

Example Room Setup:

Theater Seating

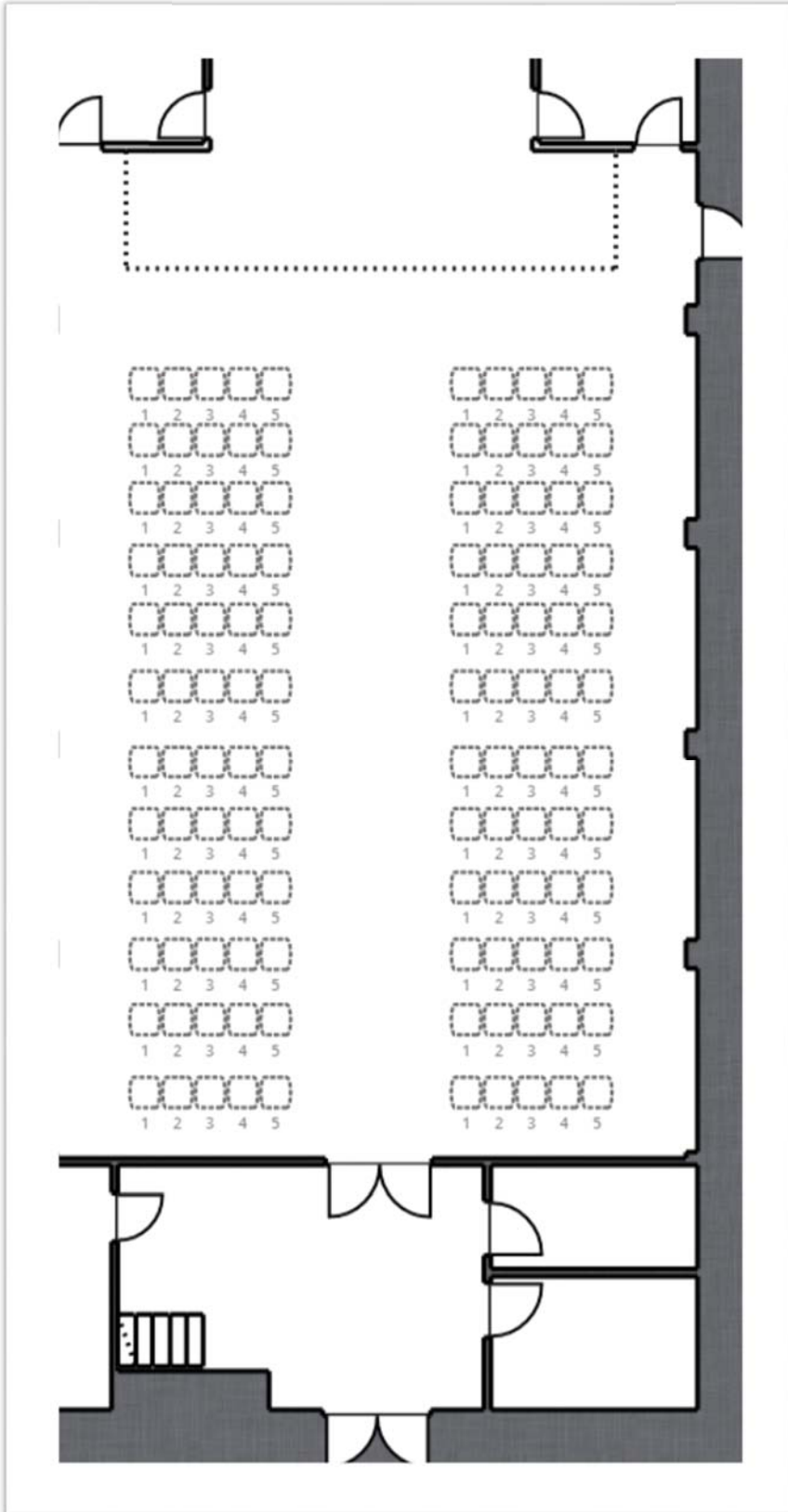

The Chapel



Fort Worden

— PORT TOWNSEND —

A HISTORIC GATHERING PLACE

Maximum Capacity:

160

Suitable for:

- * Weddings
- * Lectures
- * Workshops
- * Film screenings
- * Family reunions

Notes:

Wood floors, carpeted entry, and platform stage. There is a built in screen, a stage, & room-darkening shades.

Example Room

Setup:

Herringbone

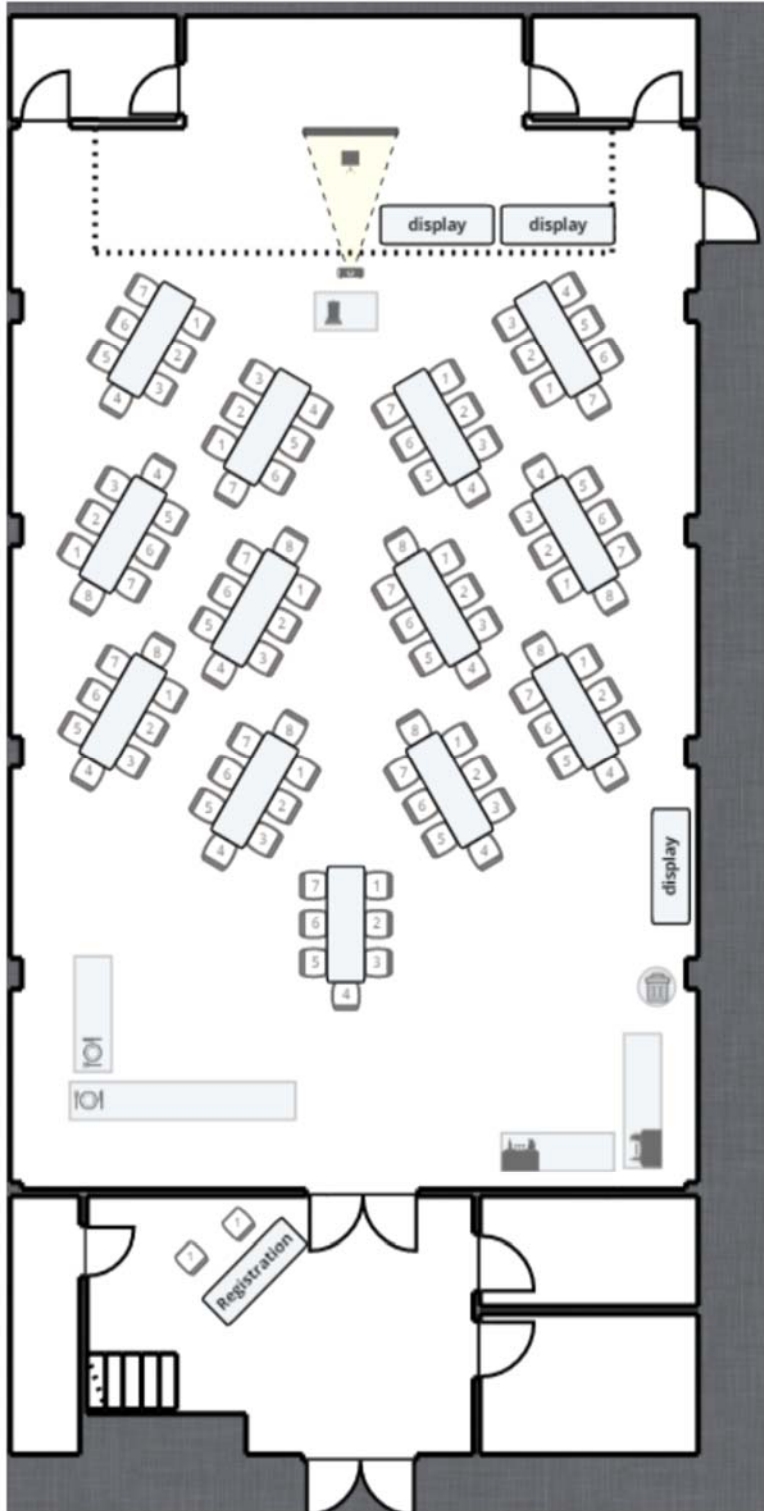

Wheeler Theater



Maximum Occupancy:

260

(*Additional seating available)

JOSEPH WHEELER
THEATER

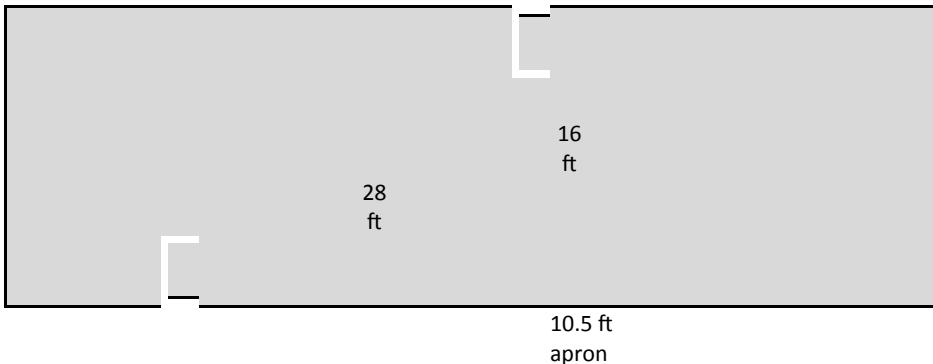

Suitable for:

- * Lectures
- * Film screenings
- * Wedding ceremonies
- * Rehearsals
- * Performances

Notes:

Historic theater equipped with box office, outdoor marquee lighting, sloped seating, house lights, & working lights. ADA

accessible,

projection screen, podium, & backstage area for special "behind the scenes" needs. Extra charges for additional lighting, tech work, & heating.

moveable
chairs

A	1	2	3	4	5	6	7	8	9	10
B	1	2	3	4	5	6	7	8	9	10
C	1	2	3	4	5	6	7	8	9	10
D	1	2	3	4	5	6	7	8	9	10
E	1	2	3	4	5	6	7	8	9	10
F	1	2	3	4	5	6	7	8	9	10
G	1	2	3	4	5	6	7	8	9	10
H	1	2	3	4	5	6	7	8	9	10
J	1	2	3	4	5	6	7	8	9	10
K	1	2	3	4	5	6	7	8	9	10
L	1	2	3	4	5	6	7	8	9	10
M	1	2	3	4	5	6	7	8	9	10
N	1	2	3	4	5	6	7	8	9	10
O	1	2	3	4	5	6	7	8	9	10

moveable
chairs

moveable
chairs

A	11	12	13	14	15	16	17	18	19	20	A
B	11	12	13	14	15	16	17	18	19	20	B
C	11	12	13	14	15	16	17	18	19	20	C
D	11	12	13	14	15	16	17	18	19	20	D
E	11	12	13	14	15	16	17	18	19	20	E
F	11	12	13	14	15	16	17	18	19	20	F
G	11	12	13	14	15	16	17	18	19	20	G
H	11	12	13	14	15	16	17	18	19	20	H
J	11	12	13	14	15	16	17	18	19	20	J
K	11	12	13	14	15	16	17	18	19	20	K
L	11	12	13	14	15	16	17	18	19	20	L
M	11	12	13	14	15	16	17	18	19	20	M
N	11	12	13	14	15	16	17	18	19	20	N
O	11	12	13	14	15	16	17	18	19	20	O

moveable
chairs

(may be used by
sound table)

Building 204



Maximum Occupancy:

204 US or 204 UN – 150

204 DN – 150

204 DS – 12-60

204 Suite – 600

Suitable for:

Meetings

Classes

Lectures

Workshops

Presentations

Notes:

Building 204 has 4 wings available individually or rented as a whole venue. Flexible meeting arrangements abound with the two upper wings being big, open spaces, and the two bottom wings being smaller, individualized rooms great for break-out workshops or smaller meetings. This building is ADA accessible with an elevator for the upper floors.

Fort Worden Commons

Maximum Capacity:

Commons A—250

Commons B or C—100

Grand Ballroom Suite—700

Suitable for:

- * Galas
- * Auctions
- * Trade Shows
- * Luncheons
- * Receptions
- * Conferences

Notes:

A multi-use facility with four potential meeting halls ranging in capacity. You may choose a combination of rooms or use them individually.

Example Room Setup:

Luncheon

*Whole Commons space too large to picture, please contact the Sales Department for a tour.

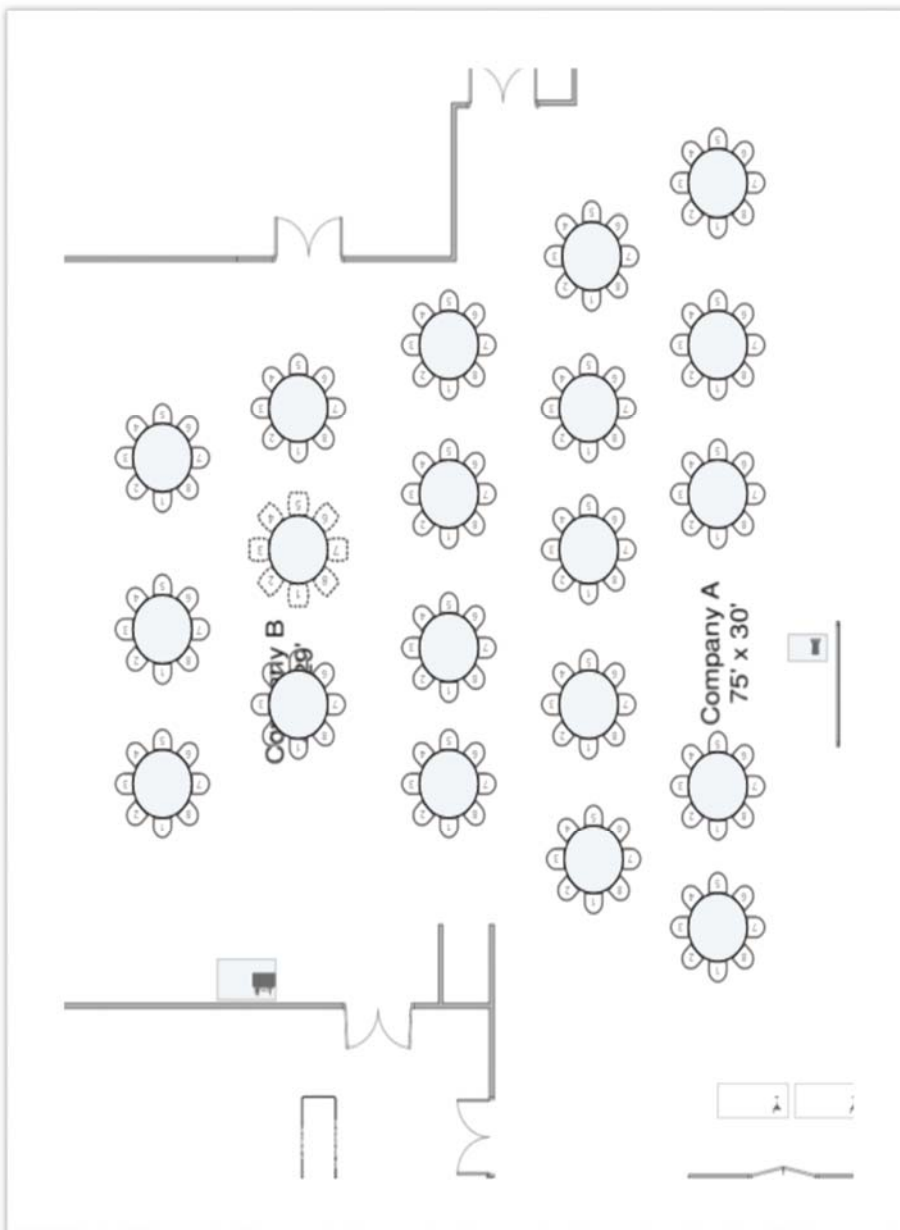

Fort Worden

— PORT TOWNSEND —

A HISTORIC GATHERING PLACE

McCurdy Pavilion



Fort Worden
— PORT TOWNSEND —
A HISTORIC GATHERING PLACE

Maximum Occupancy:

850-900 auditorium seating

additional seating available upon request

Suitable for:

- * Graduations
- * Rehearsals
- * Performances
- * Fashion Shows
- * Concerts

Notes:

ADA accessible, propane heat, and only available for rent during May through September. Large stage, outdoor lighting/bathrooms, parking across the street, and backstage access for special “behind the scenes” needs.

AV & lighting can be rented out through Centrum. PDA is trained on how to unlock/open doors—civilians will not attempt on their own.



USO Building



Maximum Capacity:

200

Suitable for:

- * Weddings
- * Performances
- * Banquets
- * Meetings
- * Trade Shows

Notes:

With a big, open dance floor, raised stage, podium, projection screen, and a smaller, carpeted area for a buffet, this space is perfect for large gatherings.

Example Room

Setup:

Family Style

